

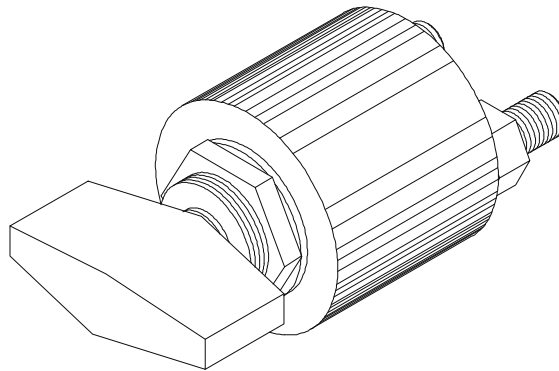

elektrosistem



UNIPOLAR BATTERY DISCONNECTING KEYSWITCH



FEATURES

The battery disconnecting switch has been designed for applications to electric vehicles in order to disconnect battery in case of serious anomalies.

Moreover the switch must be pushed when maintenance operations on electric parts are carried out.

It guarantees a perfect insurance against thefts and fire risks for vehicles parked or waiting.

Switches have small dimensions, are easy to install and are able to disconnect at peak load; moreover the opening double contact guarantees a big capacity and prevents jamming.

ASSEMBLING AND USE

• Be sure that the switch is assembled in such a position that electric arcs do not damage electric wires or other parts.

• Be sure that the cap is perfectly tightened.

• Never use as switch for vehicle running.

• No special maintenance is required but for safety purposes check switch functioning before starting the vehicle.

• It is advisable to assemble the switch in a position that can be easily reached by the operator, keeping path for cables as shorter as possible.

• Rotate the key in order to rapidly disconnect the switch.

~~NEWS~~

DIMENSIONS

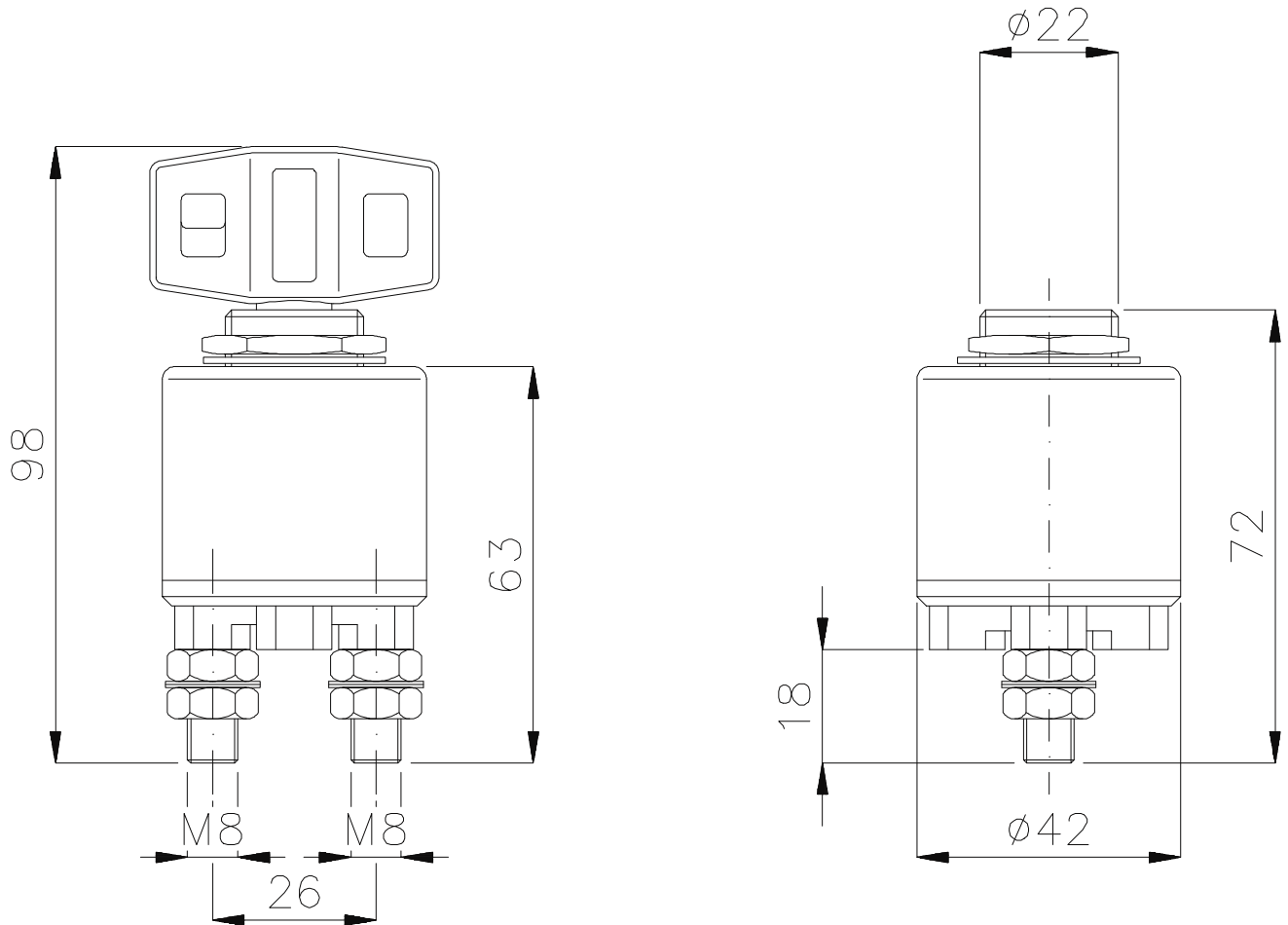

All dimensions are in mm.

SPECIFICATIONS

Current for 1 Hour at 24V	100 A
Max Current for 5"	300 A
Operating Temperature	from -40 to +80 °C
Weight	150 g